

Stainless Steel Exhaust Manifold Mount Hardware Kits



AFTERMARKET EXCLUSIVES | MAKE BETTER EXHAUST REPAIRS



03218HP

Chrysler 2007,
Dodge 2012-04,
Jeep 2007-05,
Mitsubishi 2007-06



03309HP

Chrysler 2020-05,
Dodge 2020-06,
Jeep 2020-09,
Ram 2020-11



03411HP

Ford 2017-96,
Lincoln 2014-98,
Mercury 2011-02



03413HP

Chrysler 2011-01,
General Motors
2019-96,
Isuzu 2008-03,
Saab 2009-05,
Volkswagen 2010-09



03133HP

Ford 2011-99,
General Motors
2018-90,
Isuzu 2008-03,
Nissan 2009-03,
Saab 2009-05

PROBLEM: The factory-style fasteners used to secure the exhaust manifold to the cylinder head on certain vehicles are prone to cracking and failure from extreme thermal cycles and corrosion.

FIX: These convenient Dorman OE FIX hardware kits contain application-specific studs, bolts and nuts made of 100 percent stainless steel that provide superior strength and resistance to corrosion. Each kit contains the studs, bolts and nuts required to install one exhaust manifold.

Remanufactured Transmission Control Modules



IMPROVED DESIGNS
REMANUFACTURED IN THE USA

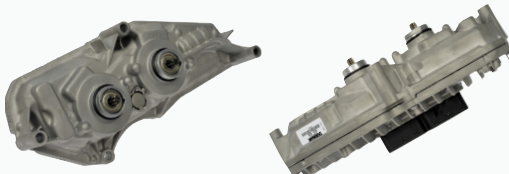

609-031

Ford Focus 2018-12

609-032

Ford Fiesta 2018-11

PROBLEM: The original equipment transmission control modules (TCM) on some Ford vehicles use compliant pin connections for critical components. Over time and normal use, the connections can become loose and begin to fail, causing automatic transmission malfunctions.

FIX: These Dorman OE FIX remanufactured transmission control modules feature more durable soldered connections on all critical component connections and 100% new seals to prevent future corrosion. The modules are remanufactured in the USA, have been performance tested against the Ford factory design, and are designed to seamlessly restore all the original factory features. Once installed, a simple and brief sequence of adaptive learning steps using a scan tool (not included) must be performed to complete the activation of these TCMs. Detailed instructions for that process are included with the modules.

Fuel Pump Driver Module



TIME-SAVING SOLUTION | IMPROVED DESIGN

THERMAL- AND
VIBRATION- TESTED
HOUSING



POWDER-COATED BACKING
PLATE INCREASES
CORROSION RESISTANCE



ENHANCED
MICROCONTROLLER AND
NEW ACTIVE ELECTRONIC
COMPONENTS FOR
INCREASED RELIABILITY

PRE-PROGRAMMED
FOR FASTER AND EASIER
INSTALLATION

601-130

Buick 2014-13, Cadillac 2014-13, Chevrolet 2016-13, GMC 2014-13

PROBLEM: When certain GM vehicles start hard, stall or run poorly, it could be because of a failing fuel pump driver module. But when the factory module fails on select models, the dealership's replacement part requires expensive calibration and programming.

FIX: This time-saving Dorman OE FIX replacement is pre-programmed for an easier and more predictable installation. It also features a thermal- and vibration-tested, powder-coated backing plate for greater resistance to corrosion, and upgraded active electronic components for added reliability.

Power Steering Cooler



AFTERMARKET EXCLUSIVE
MAKE A BETTER REPAIR

FACTORY-STYLE FITTINGS
AND HARDWARE FOR A
SEAMLESS REPAIR

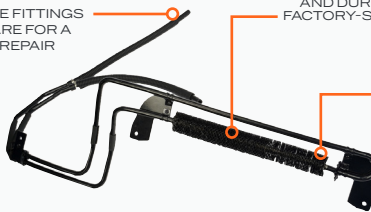

918-976

Chevrolet Silverado and GMC Sierra with V8 403 6.6L (6599cc) engines

MORE ROBUST STACKED-FIN
DESIGN FOR GREATER STRENGTH
AND DURABILITY THAN
FACTORY-STYLE WIRE FIN

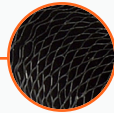

UPGRADED COOLING
FIN MATERIAL
FOR SUPERIOR
CORROSION
RESISTANCE

Exhaust Gas Temperature Sensor



SIMPLIFIES REPAIR
COMPLETE KIT WITH SENSOR, BUNG,
WELD-ON PLATE, AND ZIP TIE



904-797

Lexus LS600h 2016-08

Diesel Exhaust Fluid (DEF) Filler Necks

AFTERMARKET EXCLUSIVES | **DIRECT REPLACEMENTS**



904-064
Ford 2016-11 (with wide frame)



904-065
Ford F-350 Super Duty 2016-11, Ford F-450
Super Duty 2016-11, Ford F-550 Super Duty 2016-11



904-066
Ford 2019-17 (aft of axle fuel tank)

Battery Current Sensor

DIRECT REPLACEMENT



601-033
Ford C-Max 2018-13, Ford Escape 2019-13,
Ford Focus 2018-12, Ford Transit Connect 2018-13

Seat Bottom Cushion

AFTERMARKET EXCLUSIVE



926-859 (Front Left)
Ford 2019-15 (without heated seats)

Blind Spot Modules

DIRECT REPLACEMENTS



601-282
Ford C-Max 2018-17, Ford Focus 2018-15



601-505
Ford Bronco Sport 2022-21, Ford Escape 2022-21,
Lincoln Aviator 2022, Lincoln Corsair 2022-20